

# MENDOTA MODEL DXV-35 TOP VENT

USE ONLY DURAVENT 4"X6-5/8" COAXIAL PIPES AND VENTING COMPONENTS.

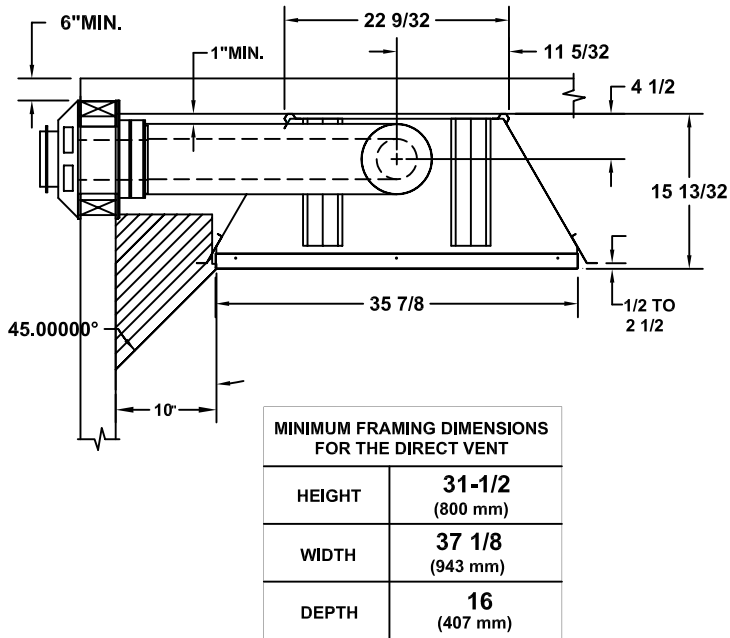

MINIMUM FRAMING DIMENSIONS FOR THE DIRECT VENT	
HEIGHT	31-1/2 (800 mm)
WIDTH	37 1/8 (943 mm)
DEPTH	16 (407 mm)

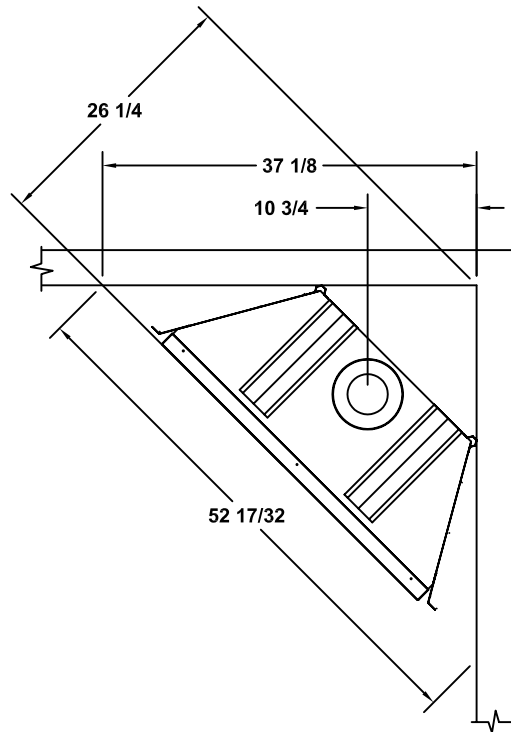

### Adjacent Walls:

A wall, perpendicular to and in front of the appliance front facing must be at least 10" from the firebox opening. A wall at 45° to the front and starting at the appliance's outer edge is permitted. Projections behind this wall (shaded area) are permitted.

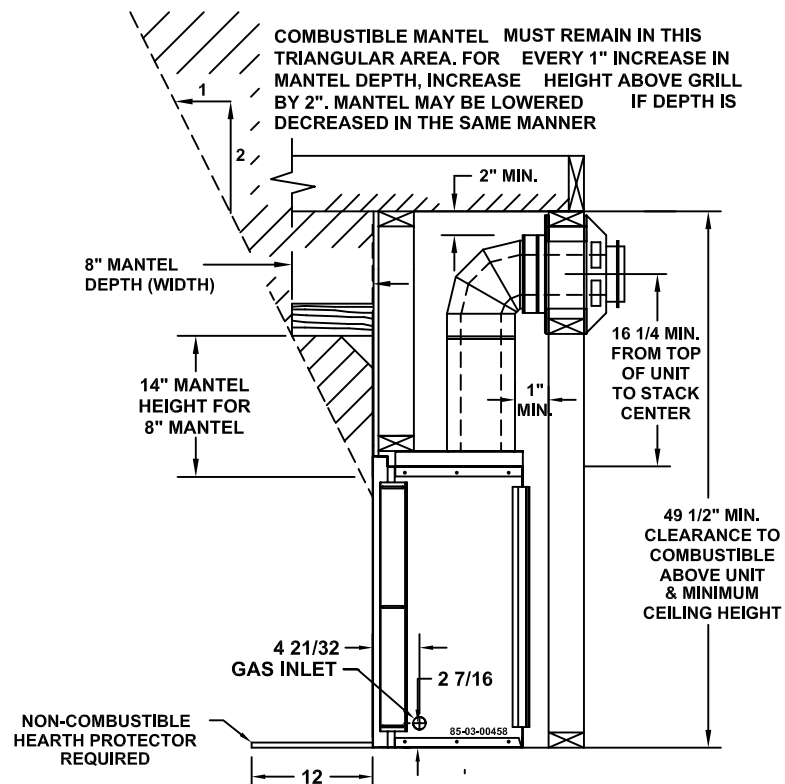
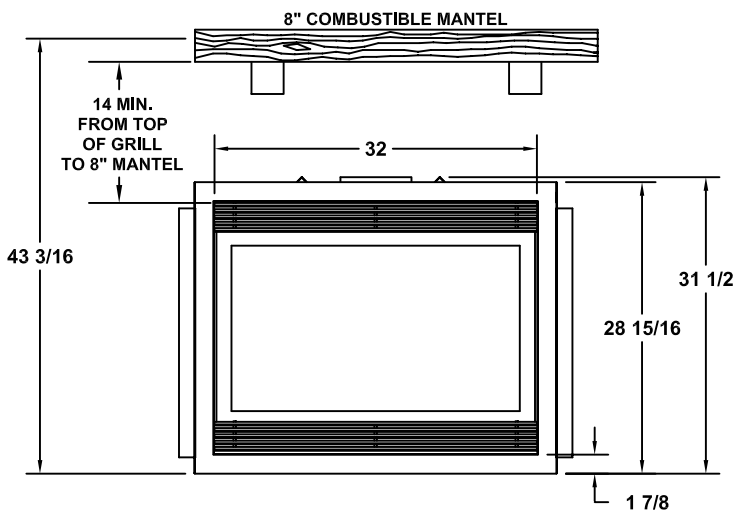

IF MANTEL IS MADE OF A NON-COMBUSTIBLE MATERIAL (BRICK, STONE, ETC.), OR HAS A STEEL PROTECTOR PLATE ON THE UNDERSIDE IT MAY BE PLACED ANYWHERE ABOVE GRILL

NOTE:  
FOR EVERY 1" THE FIREPLACE IS RAISED OFF THE FLOOR, HEARTH PROTECTOR MAY BE REDUCED BY 2".  
IF FIREPLACE IS RAISED 6" OR MORE, NO HEARTH PROTECTION IS REQUIRED.